

DEI SmartStart with EVO-ONE

Will only work with: DSMC200, DSMC250, VSMC200, VSMC250

- Plug in the Flash-Link-2 updater into the computer's USB port with the provided USB cable.

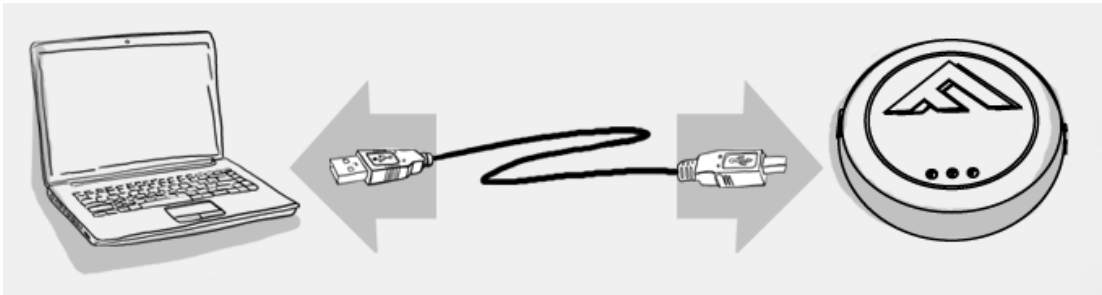

- Run Flash Link Manager Software.



- Click TOGGLE to switch to remote starter connection mode.



- Plug in the EVO-ONE with provided DATALINK cable.

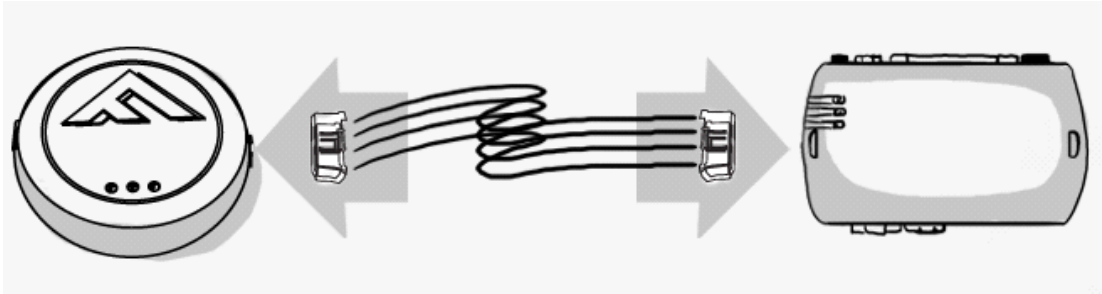

- Click configuration and then Unit Options.

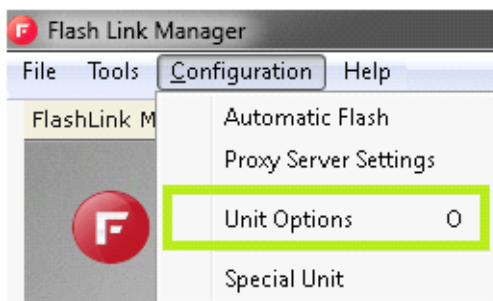

- Select XL202, click SAVE and disconnect the EVO-ONE

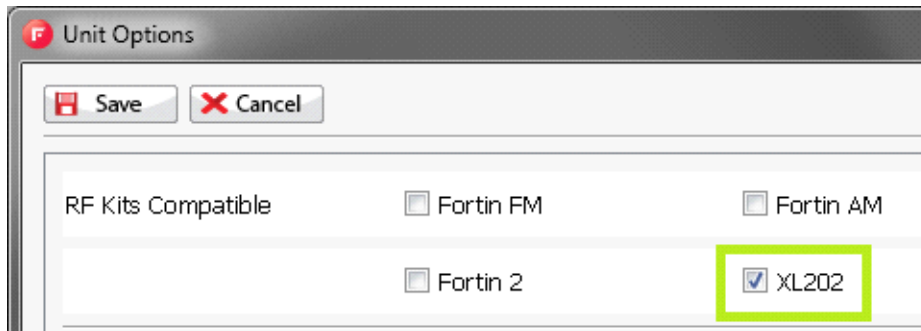

- Ground the DEI SmartStart Grey wire as shown.

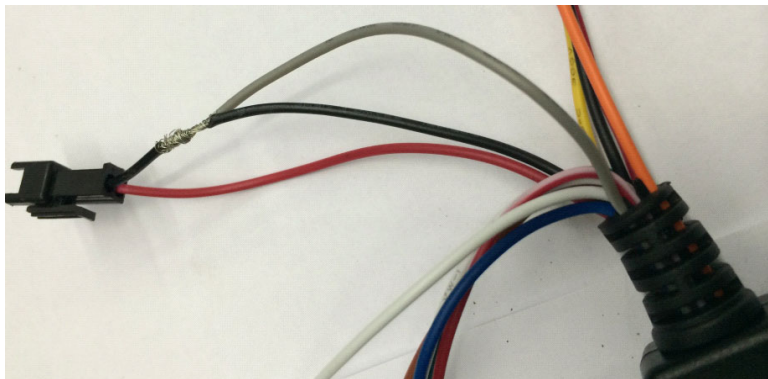





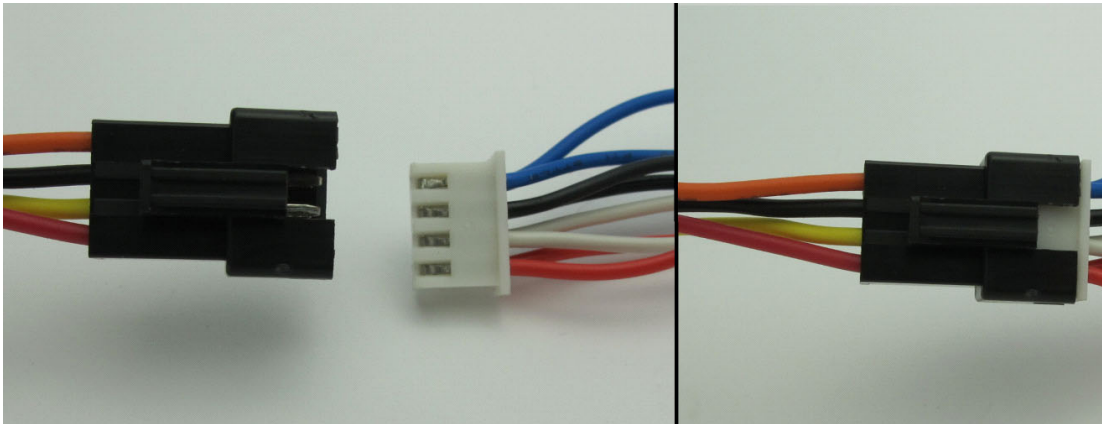
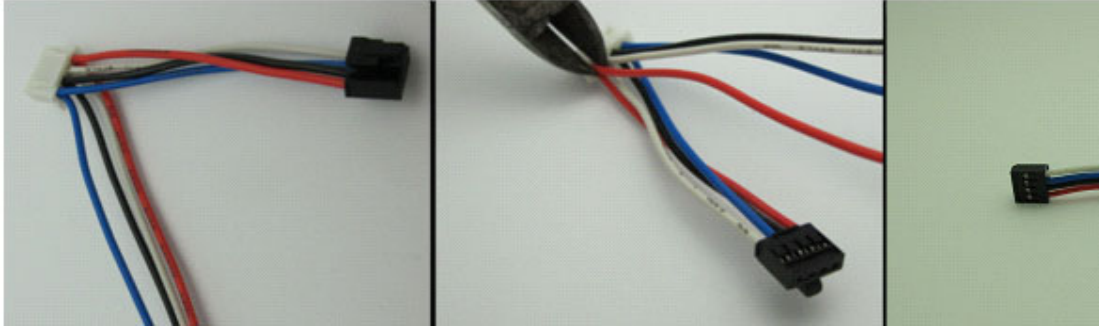

- Connect the SmartStart and the EVO-ONE together with the supplied cable. Or modify a Fortin DataLink cable as shown.

DIY Cable:



- Wait until the SmartStart initialize and connect to the network. Can take up to a minute.
- To program the Remotes on the EVO-ONE, Turn IGNITION ON. Press and hold Valet switch until the side red light flash on EVO-ONE then release. Press and release the Valet switch 5 times. Press and release the Brake

pedal once. Send lock command with the SmartStart interface. Turn IGNITION OFF.

<p>STEP 1</p>  <p>Turn the Ignition on.</p>	<p>STEP 2</p>  <p>Press and hold the valet-switch until the LED flashes, then release.</p>	<p>STEP 3</p>  <p>Press and release the valet-switch 5X. The park-lights will flash to confirm.</p>	<p>STEP 4</p>  <p>Press and release the brake pedal once.</p>	<p>STEP 5</p>  <p>press the LOCK button once the park-lights will flash to confirm</p>	<p>STEP</p>  <p>Press release brake-p once</p>
--	---	--	--	---	---

If you want to change EVO-ONE options, use the following button mapping:

mode 1 : Lock

mode 2 : Unlock

mode 3 : Trunk

mode 4 : Start

mode 5 : Aux1

mode 6 : Aux2